

Enquiry N°:
Created by: DB / Approved by: JD

SERVO MOTOR 089LDC106FFCTC

089LDC106FFCTC



Definition

Type	Unimotor HD	
Frame Size (mm)	089	
Voltage	L	48 Vdc
Magnet type	D	High Dynamic
Frame Length	C	
Speed (min ⁻¹)	10	1000
Brake	6	Braked
Connection type	F	Flying leads 0.5m Power cut ends, Signal 16-way Molex connector
Output shaft	F	Half key and full key supplied in bag
Feedback device code	CT	4096 ppr Incremental encoder (TDK)
Inertia & thermistor	C	Standard inertia + KTY84-130 thermistor
PCD	100	100 (FF 100 / 80)
Shaft Diameter	190	19j6 x 40.0
Fan Box	-	
Insulation class	F	
UL Motor / UL Stator	UL Stator	

Nominal characteristics

Motor Ambient Temperature (°C)	40	Drive Fsw (kHz)	12
Motor Stall Torque (Nm)	8.0	Stall Current (A)	19
Rated Torque (Nm)	7.8	Nominal Current (A)	19.5
Motor Peak Torque (Nm)	24.0	Kt (Nm/A)	0.4
Rated Power (kW)	0.8	Ke (V/kmin ⁻¹)	25.6
Winding Thermal Time Constant (s)	98	R (ph-ph) (Ohm)	0.15
Number of Poles	10	L (ph-ph) (mH)	1.1
Typical Cogging (Nm)	0.12		
Inertia (kg.cm ²)	2.6	Weight (kg)	~6.6
Ingress Protection Level (IP)	IP54		
Brake	Type 6	Static Torque (N.m)	10
Release Time (ms)	110	Backlash (°)	3
Brake Supply Voltage (V)	24	Brake Coil Power (W)	18

Torque / speed graph

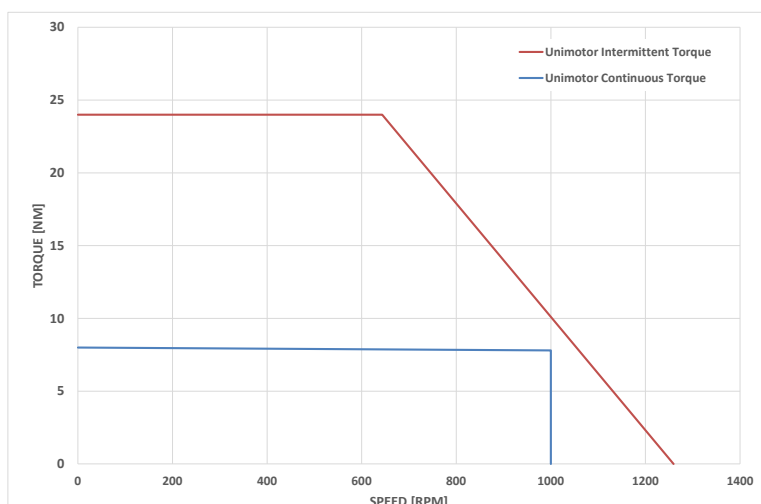

Enquiry N°:

Created by: DB / Approved by: JD

SERVO MOTOR 089LDC106FFCTC

Motors (° & mm)

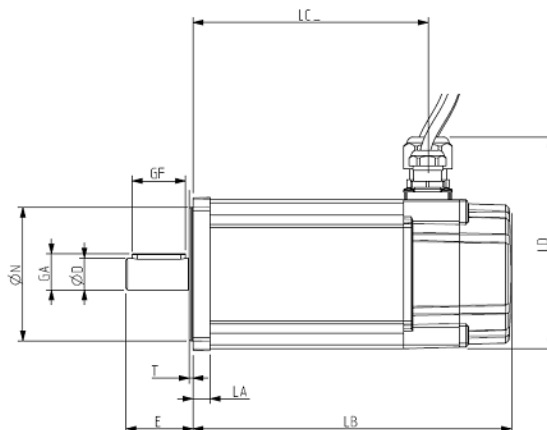
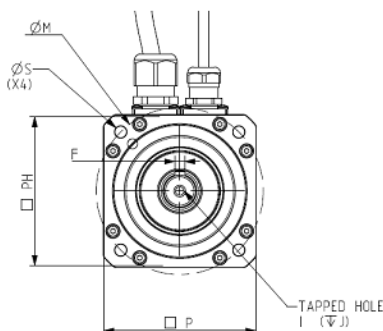

LB	Total length	237.9
LC	Signal connector position	210.6
LA	Flange thickness	10.3
T	Register Length	2.2
N	Register Diameter	80.0
LD	Connector overall height	~119
P	Flange Square	91.0
S	Fixing Hole Diameter	7.0
M	Fixing hole PCD	100.0
PH	Motor Housing Width	89.0
D	Shaft Diameter	19j6
E	Shaft Length	40.0
GA	Key Height	21.5
GF	Key Length	32.0
G	Key to Shaft End	3.7
F	Key Width	6.0
I	Tapped Hole Thread Size	M6 x 1.0
J	Tapped Hole Depth	17.0
	Mounting Bolt	M6

Motor electrical interface Connectors option:

Feedback device code: CT - 4096 ppr Incremental encoder (TDK),
43025-1600 Molex 16-way female signal connector (0.5m lead)

Connection type: Flying leads 0.5m Power cut ends, Signal 16-way
Molex connector

SIGNAL FUNCTION	PIN END B
Thermistor	1
Thermistor	2
CH S1	3
CH S2	4
CH S3	5
CH A	6
CH B	7
CH Z	8
GND	9
VCC	10
CH S1-	11
CH S2-	12
CH S3-	13
CH A-	14
CH B-	15
CH Z-	16

PIN DETAIL

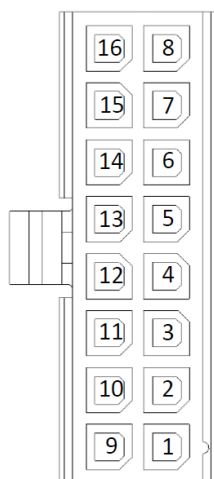

16 - WAY CONNECTOR

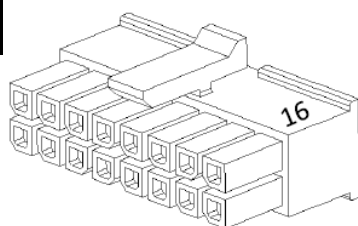

POWER FLYING LEADS:

500mm from M16 gland to cable end
8 cores of 18 AWG UL 1330 wire, with
polyolefin heat-shrink sleeve

ORANGE (x 2)	U
RED (x 2)	V
YELLOW (x 2)	W
GREEN / YELLOW (x 2)	Earth

Brake connection: 0.5m flying lead

2 cores of 24 AWG UL1330 white wire, insulated: 500mm (from gland to customer end). 2-Way Molex minifit connector 39-01-3023

Brake connections

Pin 1	White	+ve
Pin 2	White	-ve



Enquiry N°:
Created by: DB / Approved by: JD

SERVO MOTOR 089LDC106FFCTC

CT Encoder

Manufacturer:	CTD / Motion TDK
Model:	Magnetic
Signal periods:	4096
Output interface:	Differential
Supply voltage:	5V +/- 10%
Accuracy	±0.2 Deg